

Proj. # 10-0208
 Date 02/27/11
 Designed by BJS
 Drawn by BJS
 Checked by BJS
 Revised
 Sheet No. A-1
 1 of 2 Sheets

STAPLES ARCHITECTURAL SERVICES
 BRIAN J. STAPLES - ARCHITECT
 W7898 CREEK ROAD
 DELAVAN, WI, 53115
 PHONE: (262)948-0922 E-MAIL: staplesarch@charter.net

EXTERIOR ELEVATIONS

VETERANS PARK SHELTER
 CITY of MILTON
 HILLTOP DRIVE & ORCHARD ROW
 CITY of MILTON, ROCK COUNTY, WISCONSIN

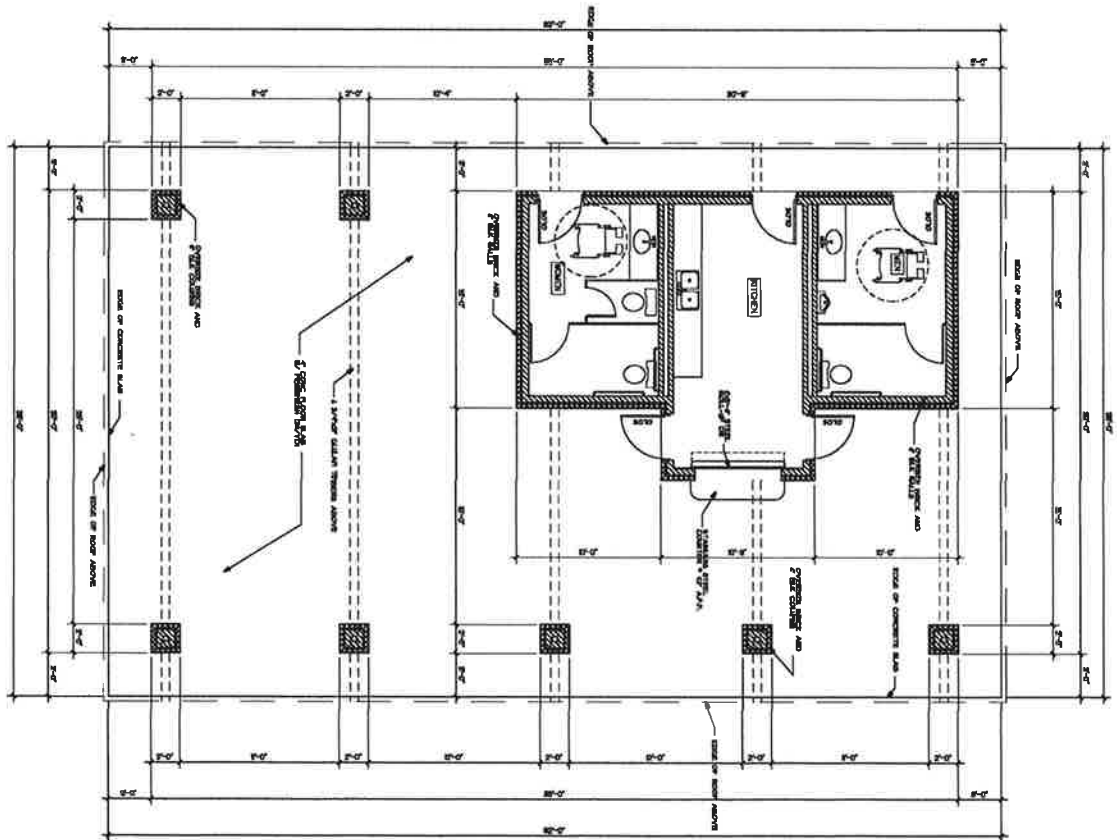

FIRST FLOOR PLAN

Project: 001001
 Date: 04/11/11
 Drawn by: B.J.S.
 Checked by: B.J.S.
 Revised: _____
 Sheet No. A-2
 2 of 2 Sheets

STAPLES ARCHITECTURAL SERVICES
 BRIAN J. STAPLES - ARCHITECT
 7789B CREEK ROAD
 DELAVAN, WI. 53115
 PHONE: (262) 649-0822 E-MAIL: staplesarch@staplesarch.com

FIRST FLOOR PLAN

VETERANS PARK SHELTER
 CITY of MILTON
 HILLTOP DRIVE & ORCHARD ROW
 CITY of MILTON, ROCK COUNTY, WISCONSIN

DATE 5/7/19	 <p>Construction Options Inc.</p> <ul style="list-style-type: none"> Commercial Buildings Design Consultation & Estimating "Hands-On" Project Management New Buildings, Additions & Repairs <p>6247 Vickerman Road · Milton, WI 53563</p>	608-868-5320 dfvickerman@hotmail.com	Sheet No. 1 of 2
PROJECT Veterans Park Milton		Calculated by [Signature]	Scale 1/8" = 1'0"

SPECIFICATIONS

